

weekly   
**BIBLE**  
classes

**April 6**  
*thru*  
**June 11**

“Study to show thyself approved unto God,  
a workman that needeth not to be ashamed,  
rightly dividing the word of truth.”

(2 Timothy 2:15)



# Adults, Sr. High & Jr. High

## Sunday Mornings at 9:00 A.M.

(April 6 thru June 8)

Auditorium	Second Samuel	Dan Jenkins
Adult 1-2	<i>Influencing Others</i>	Jeff Goodale
Adult 3	Young Adults: <i>Practical Christian Living</i>	Kirk Crews
Jr. High & Sr. High	Romans & Galatians	Robert Lupo

## Wednesday Evenings at 7:00 P.M.

(April 9 thru June 11)

Auditorium	Enduring Life Principles from the Ten Commandments	David Sproule
Adult 1-2	<i>Looking at Two Uninspired Books</i>	Dan Jenkins
Jr. High & Sr. High	World Religions	Robert Lupo

# Children's Bible Education & Experience

## Age 3 thru Grade 5

Semester #13: **January 26** thru **June 11**

	The Church Begins	The Church in Jerusalem	The Church Grows	Saul Converted	The Apostle Peter
<b>Session 1</b> <i>Jan. 26 thru Feb. 19</i>	<b>Grades 4-5</b> <i>Robert Lupo</i>	<b>Ages 3-4</b> <i>Trish Clark</i>		<b>K-Grade 1</b> <i>Lisa Metzkes &amp; M. Porter</i>	<b>Grade 2-3</b> <i>Jennifer Goodale</i>
<b>Session 2</b> <i>Feb. 23 thru Mar. 19</i>	<b>Grade 2-3</b> <i>Jennifer Goodale</i>	<b>Grades 4-5</b> <i>Robert Lupo</i>	<b>Ages 3-4</b> <i>Trish Clark</i>		<b>K-Grade 1</b> <i>Lisa Metzkes &amp; M. Porter</i>
<b>Session 3</b> <i>Mar. 23 thru Apr. 16</i>	<b>K-Grade 1</b> <i>Brenda Collier</i>	<b>Grade 2-3</b> <i>Reanna Lupo</i>	<b>Grades 4-5</b> <i>Dan McLeod</i>	<b>Ages 3-4</b> <i>Peggy Hall</i>	
<b>Session 4</b> <i>Apr. 20 thru May 14</i>		<b>K-Grade 1</b> <i>Brenda Collier</i>	<b>Grade 2-3</b> <i>Reanna Lupo</i>	<b>Grades 4-5</b> <i>Dan McLeod</i>	<b>Ages 3-4</b> <i>Peggy Hall</i>
<b>Session 5</b> <i>May 18 thru June 11</i>	<b>Ages 3-4</b> <i>Peggy Hall</i>		<b>K-Grade 1</b> <i>Brenda Collier</i>	<b>Grade 2-3</b> <i>Reanna Lupo</i>	<b>Grades 4-5</b> <i>Dan McLeod</i>

## Babies thru Age 2

	<b>Cradle Roll</b>	<b>Toddlers &amp; Age 2</b>
<i>March thru May</i>	<b>God Made Families</b> <i>Maria Hackshaw</i>	<b>Moses</b> <i>Sandy Colage &amp; Tina Wagner</i>

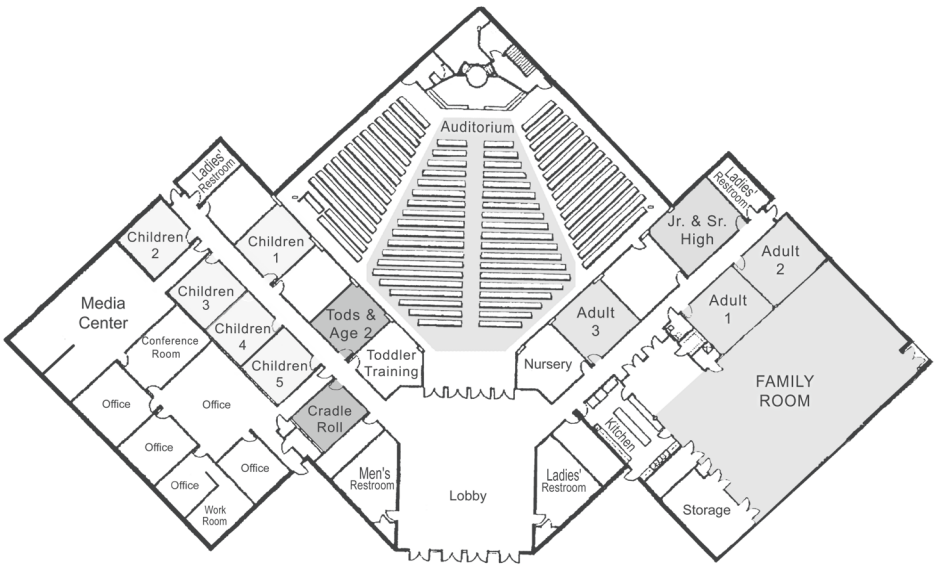

## Schedule of Services

### Sunday:

Bible Classes 9 a.m.  
 Morning Worship 10 a.m.  
 Evening Worship 6 p.m.

### Wednesday:

Bible Classes 7 p.m.

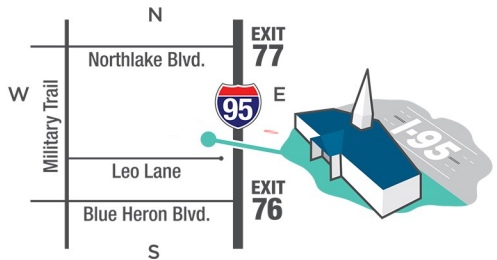

**Palm Beach Lakes**  
**CHURCH OF CHRIST**

561.848.1111 | [pblcoc.org](http://pblcoc.org) | 4067 Leo Lane | Palm Beach Gardens, FL 33410

Restoring First-Century Christianity in the Twenty-First Century